



MULTICAL® 403





MULTICAL® 403



> 60 °C













230 VAC



16/25 bar



	04
	05
	07
	12
	19
	22
	24
	27
	28
	31



https://guides.kamstrup.com/userguides/gb_mc403.htm



<https://www.kamstrup.com/en-en/heat-solutions/meters-devices/meters/multical-403/documents>



<https://www.kamstrup.com/>



1/2

MID EN 1434
 θ: 2 °C...180 °C Δθ: 3K...178K
 DK-BEK 1178 EN 1434
 θ: 2 °C...180 °C Δθ: 3K...178K
 θq: 2°C...130°C



E1 E2 M1 M2
 5°C...55°C
 IP 54
 IP 68

> 25 CM



2/2



- | | |
|------------------------------|---|
| Data + : HC-003-10 | ✓ |
| Data + : HC-003-11 | ✓ |
| M-Bus + : HC-003-20 | ✓ |
| M-Bus + : HC-003-21 | ✓ |
| wM-Bus + : HC-003-30 | ✓ |

F 28



- | | |
|----------------------------|---|
| 1xD : HC-993-02 | ✓ |
| 230 VAC : HC-993-07 | ✓ |
| 24 VAC : HC-993-08 | ✓ |
| 2xA : HC-993-09 | ✓ |

F 29



- | | |
|---------------------------|---|
| 2 x Pt500, DS, L = 1.5 m | ✓ |
| 2 x Pt500, DS, L = 3 m | ✓ |
| 2 x Pt500, PL, L = 1.5 m | ✓ |
| 4 x Pt500, PL, L = 3 m | ✓ |

F 30



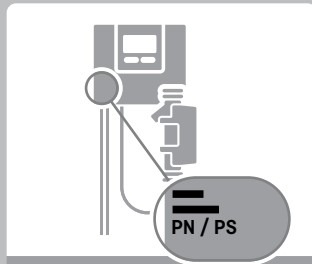

- PN16, PS16 ✓
- PN25, PS25 ✓
- PN16/PN25, PS25 ✓

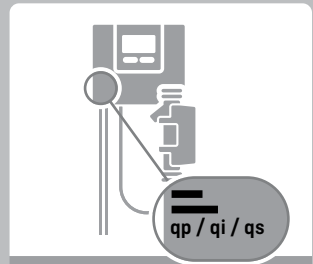

- qp: XX m³/h ✓
- qi: XX l/h ✓
- qs: XX m³/h ✓

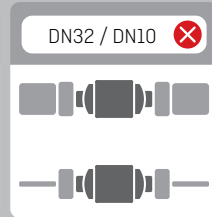
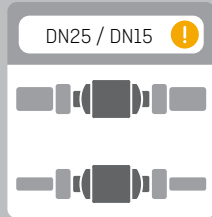
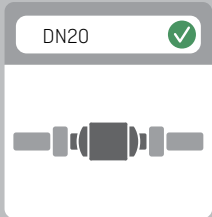
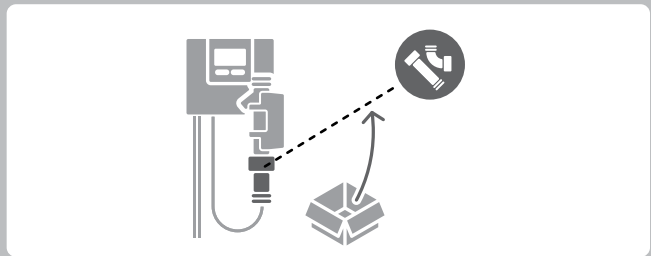

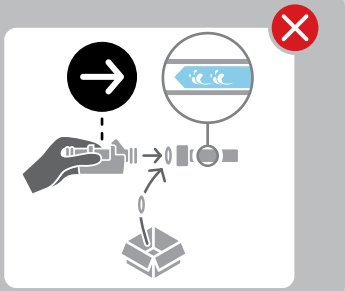
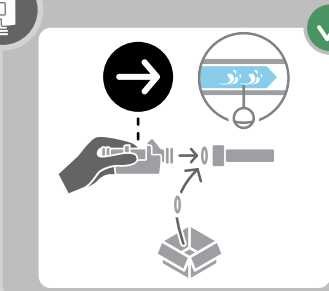
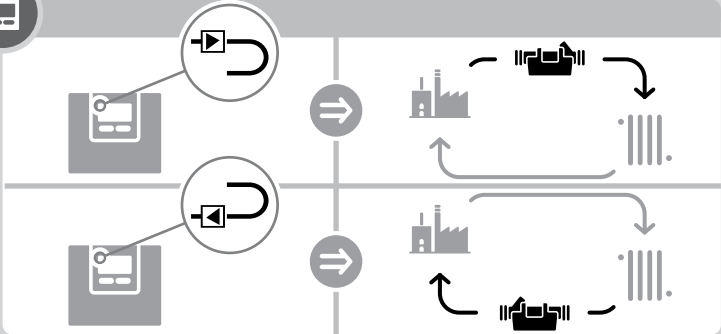
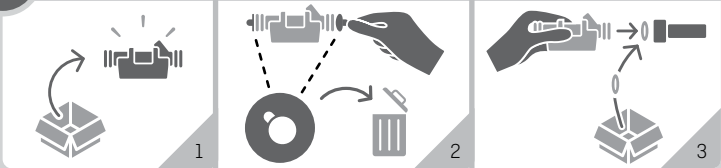



47

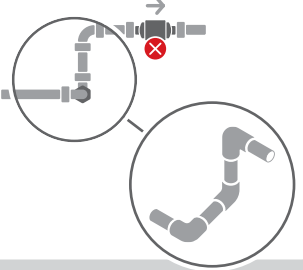
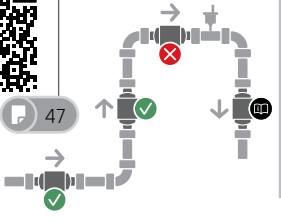

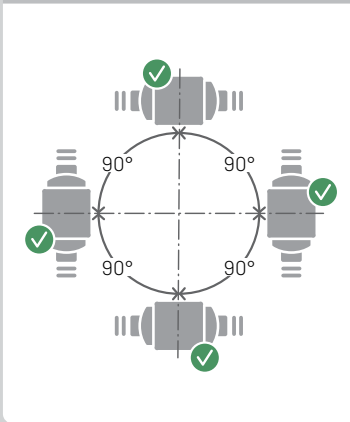

qp 0.6...2.5 m³/h



qp ≥ 3.5 m³/h

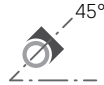

qp ≥ 6.0 m³/h

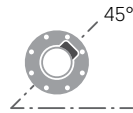



qp 0.6...2.5 m³/h



49

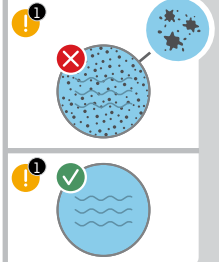
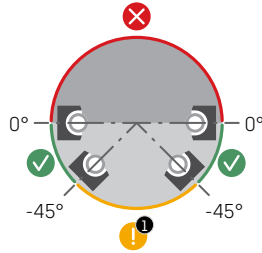

qp ≥ 3.5 m³/h



qp ≥ 6.0 m³/h

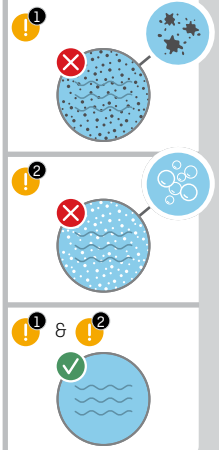
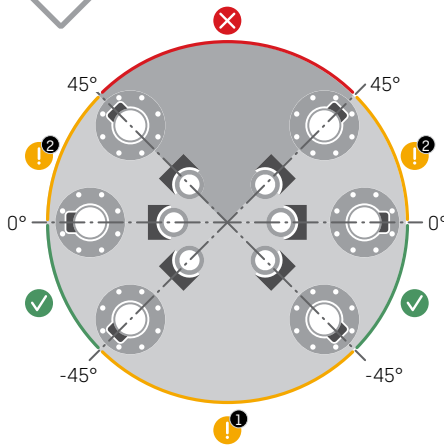

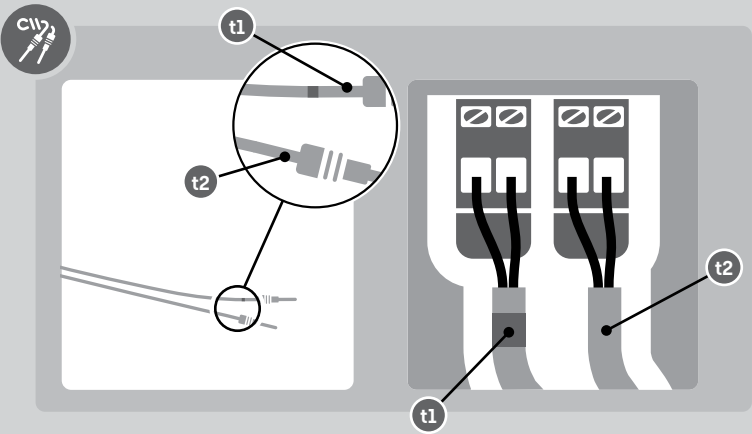
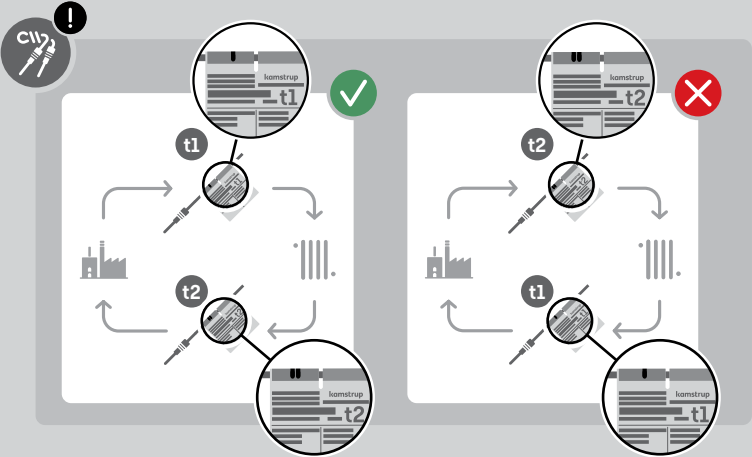



[x1] t1 [x2] t2 [x0] t3

	t1	t2	/ t3
/			

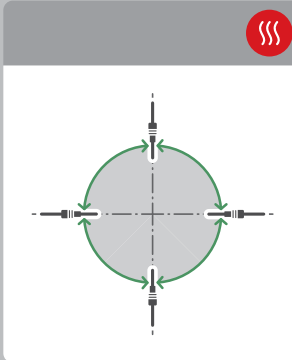
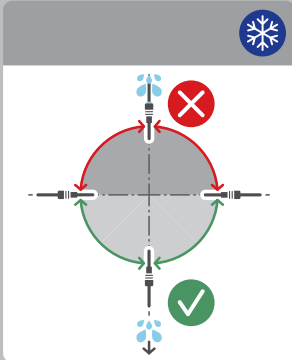
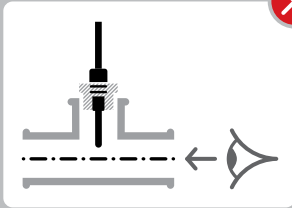
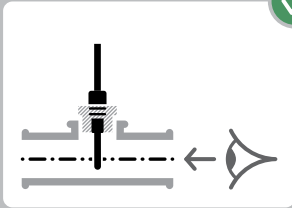



PN16 ✓

PN25 ✓



PN16 ✓

PN25 ✓



qp	DN	G
0.6-1.5	15	G¾B
0.6-1.5	20	G1B
3.5-6	25	G5/4B
10	40	G2B
15	50	-



+ CIW ✓
DS 27.5
X
X
X

+ CIW ✓
DS 38
X

+ CIW ✗
PL Ø5.8
X

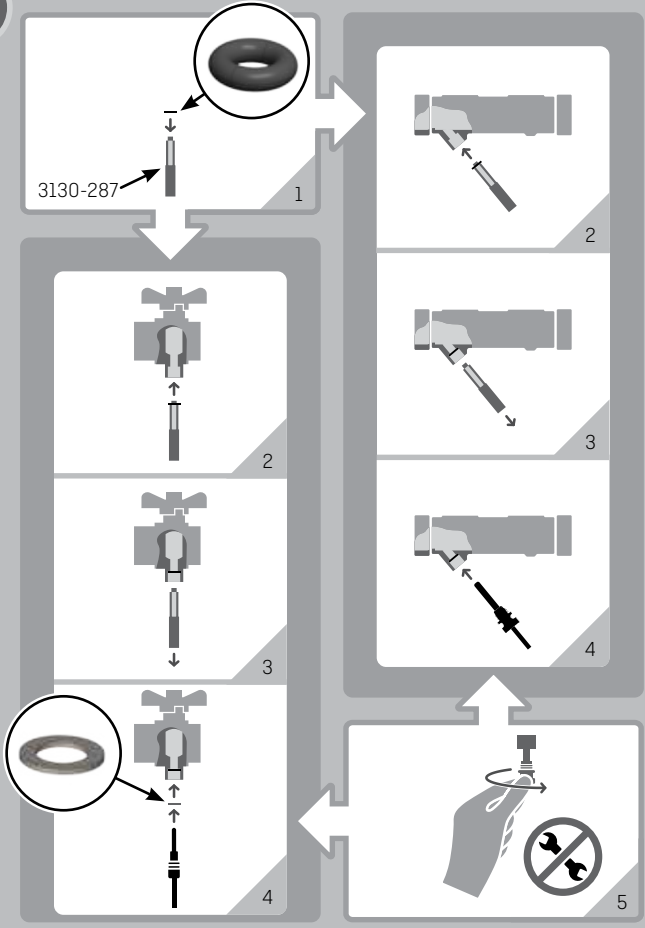

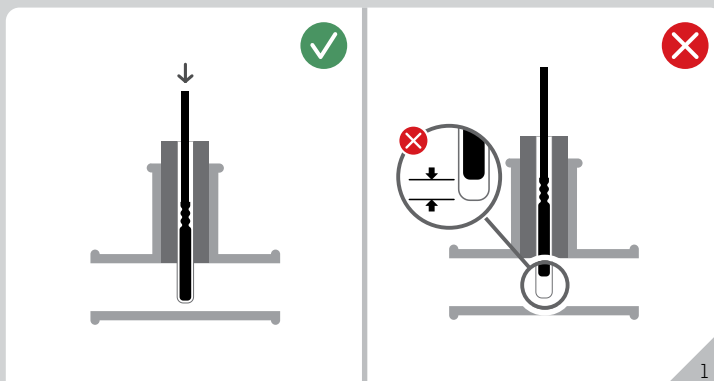
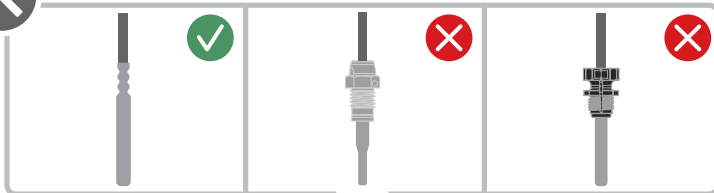

1

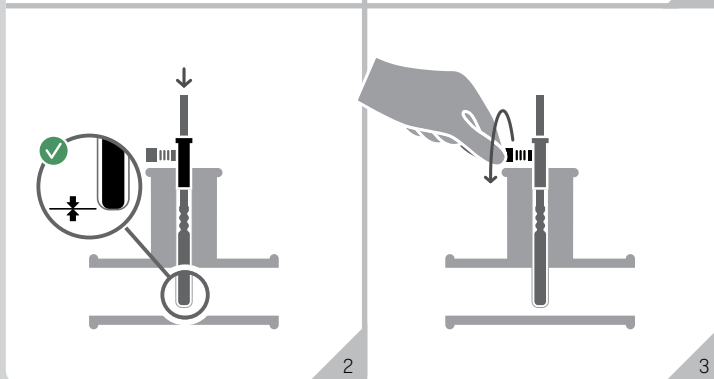

2

3



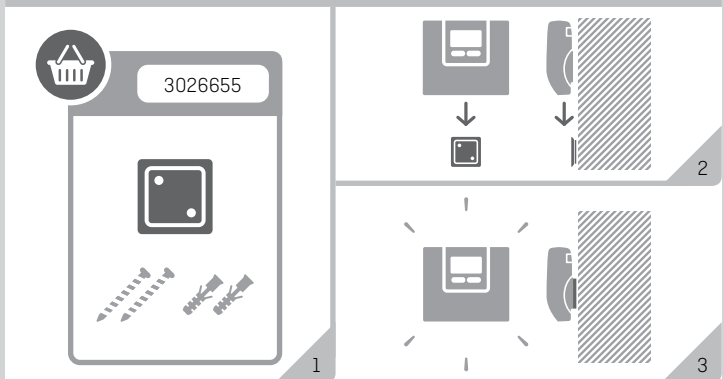
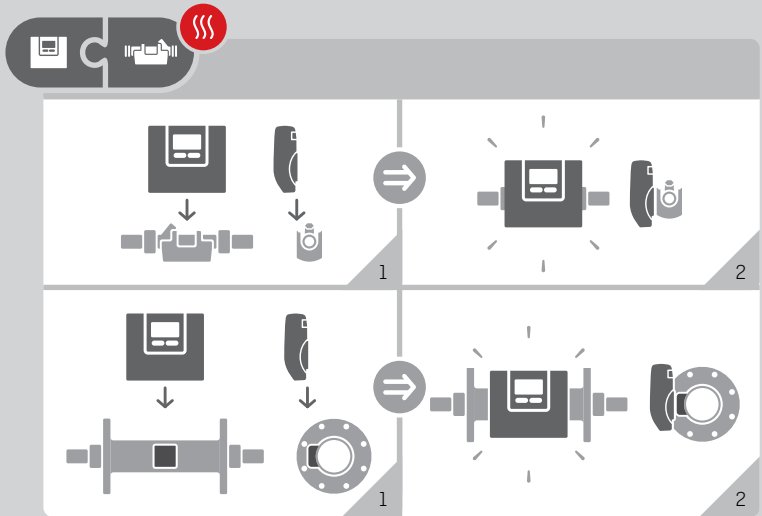



$q_p > 2.5 \text{ m}^3/\text{h}$ ✓



$\theta_q > 90 \text{ }^\circ\text{C}$ ✓



$\theta_q < \text{RT}$ ✓

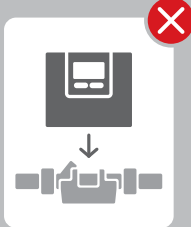
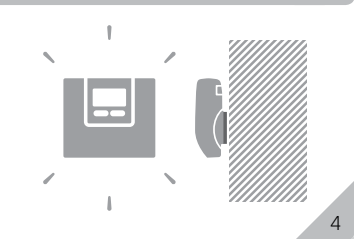
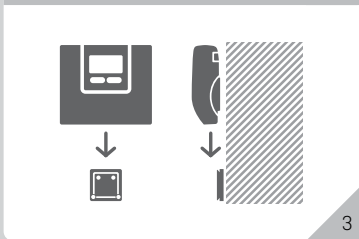
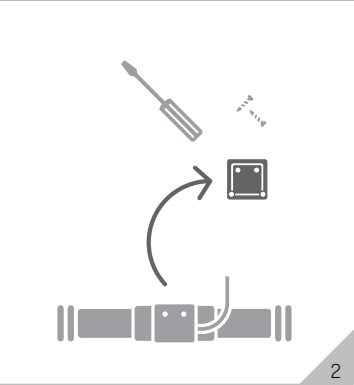
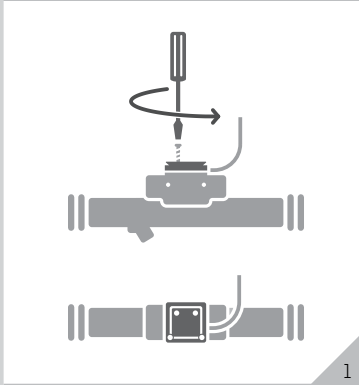

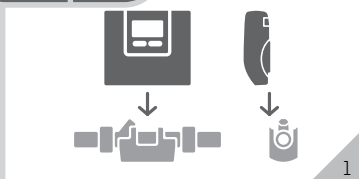

1

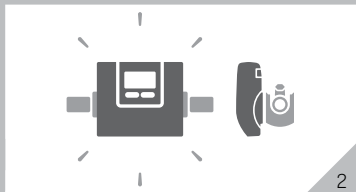

2

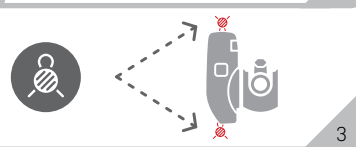
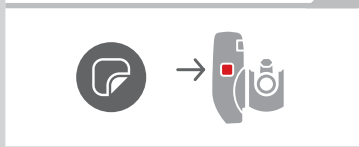

3

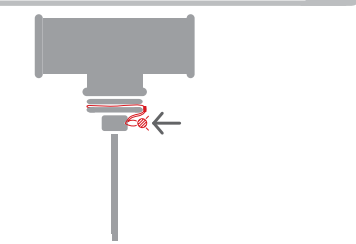
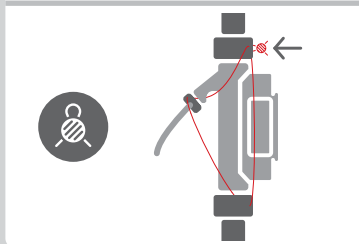

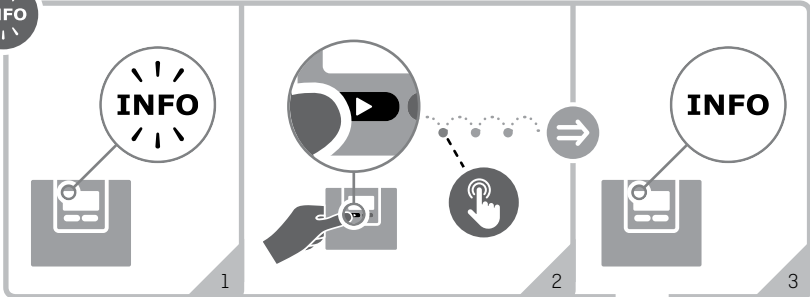

1/2

	Info	t1	t2	0	V1	0	In-A	In-B	
1									
2									
9									
	1								t1 > 185 °C
		1							t2 > 185 °C



INFO

Info	t1	t2	0	V1	0	In-A	In-B
	2						
		2					
	9	9					
				3			
				4			
				6			
						8	
						9	
						8	
						9	

$t1 < 0\text{ }^{\circ}\text{C}$

$t2 < 0\text{ }^{\circ}\text{C}$

$\Delta t (t1 - t2) = \text{X}$

V1:

V1:

$V1 > q_s$

A:

A:

B:

B:

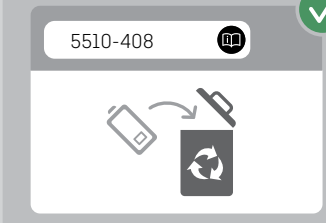
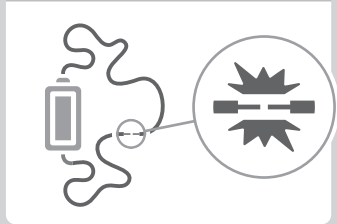
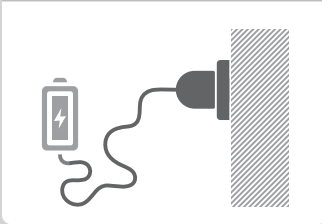



230 VAC / 50 Hz / 1 W



230 VAC / 50 Hz / 1 W

24 VAC / 50 Hz / 1 W



24 VAC / 50 Hz / 1 W

230 VAC

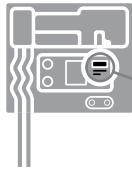

230 VAC

24 VAC

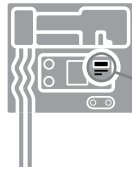

24 VAC



d = 5...8 mm

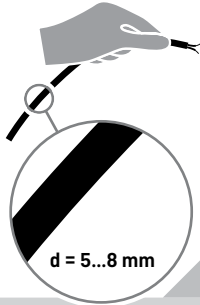

1

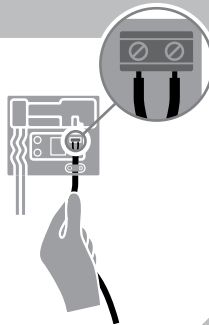

2

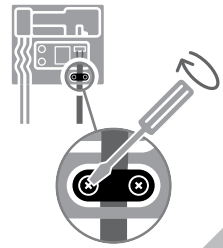

3

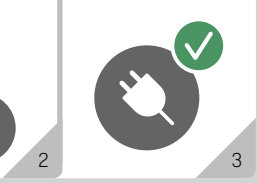
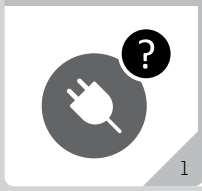

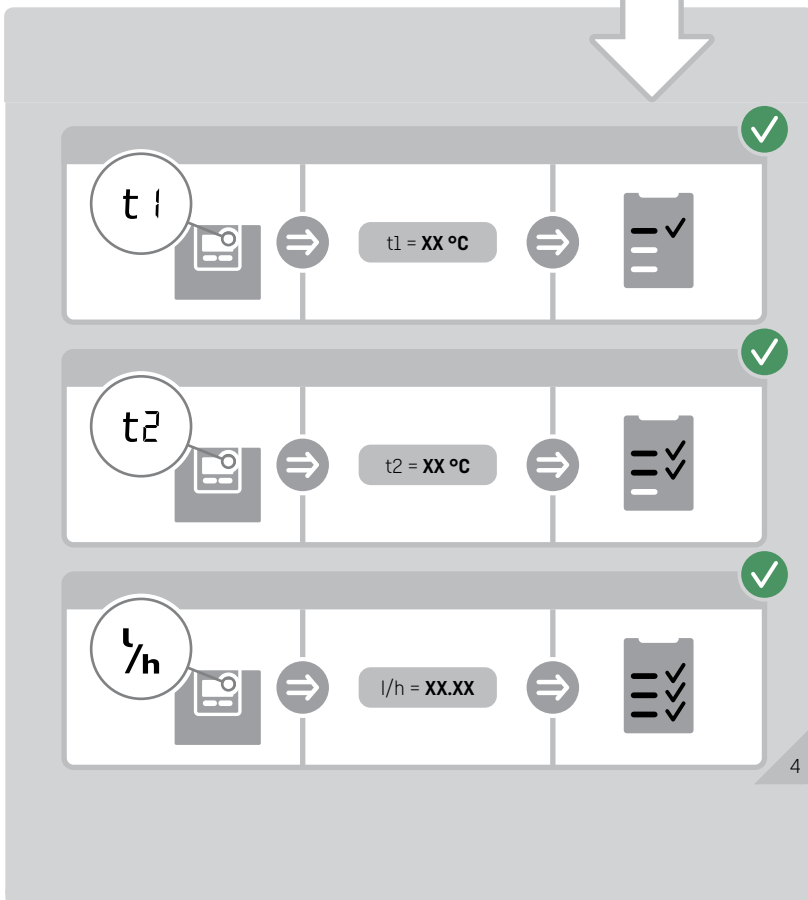
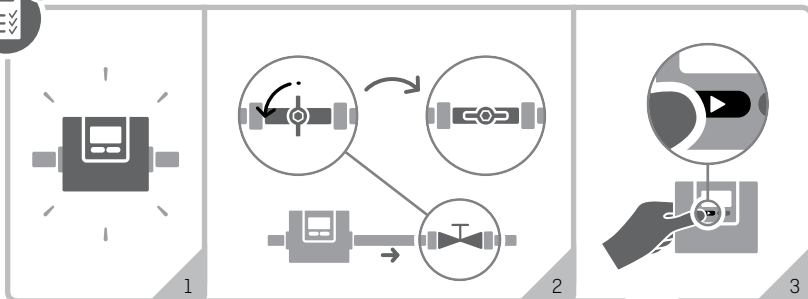



<https://www.kamstrup.com/en-en/heat-solutions/meters-devices/meters/multical-403> ✓



Data +	HC-003-10	✓
Data +	HC-003-11	✓
M-Bus +	HC-003-20	✓
M-Bus +	HC-003-21	✓
M-Bus +	HC-003-22	✓
linkIQ/wM-Bus +	HC-003-32	✓
linkIQ/wM-Bus +	HC-003-33	✓
wM-Bus+	HC-003-34	✓
Analog	HC-003-40	✓
PQT+	HC-003-43	✓
Radio +	HC-003-50	✓
Radio GDPR +	HC-003-51	✓
NB-IoT +	HC-003-56	✓
BACnet +	HC-003-66	✓
Modbus RTU +	HC-003-67	✓
BACnet IP +	HC-003-81	✓
Modbus +	HC-003-82	✓

= In-A / In-B

= Out-C / Out-D

= Out 1 / Out 2



<https://www.kamstrup.com/en-en/heat-solutions/meters-devices/accessories>

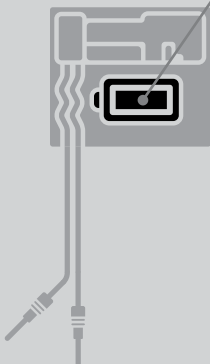

1xD	HC-993-02	✓
230 VAC ⚡	HC-993-03	✓
24 VAC/VDC ⚡	HC-993-04	✓
1xC IoT	HC-993-06	✓
230 VAC	HC-993-07	✓
24 VAC	HC-993-08	✓
2xA	HC-993-09	✓



<https://www.kamstrup.com/en-en/heat-solutions/meters-devices/temperature-sensors>

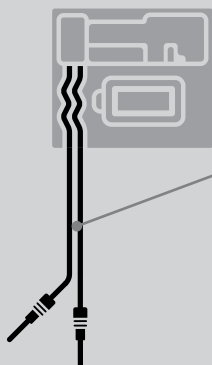

- 2 x Pt500, DS, L = 1.5 m
- 2 x Pt500, DS, L = 3 m
- 2 x Pt500, PL, L = 1.5 m
- 4 x Pt500, PL, L = 3 m



The diagram illustrates the navigation of the device's menu. A central hand icon with a magnifying glass is surrounded by a large rounded rectangle. Arrows point from this central area to various data screens:

- Top Row:**
 - Screen 1: VOL 0034732 m² (A)
 - Screen 2: 15.7 kW (kW)
 - Screen 3: 0.343 l/h (l/h)
- Left Column:**
 - Screen 4: EL 0014958 kWh (B)
 - Screen 5: TA 2 0009089 MWh (TA2)
 - Screen 6: TA 3 0005453 MWh (TA3)
 - Screen 7: TA 4 0003635 MWh (TA4)
 - Screen 8: INFO 00000000 (INFO)
- Right Column:**
 - Screen 9: t 12 39.38 °C (t 12)
 - Screen 10: t 2 27.14 °C (t 2)
 - Screen 11: t 1 66.52 °C (t 1)
 - Screen 12: 0026280 h (h)
 - Screen 13: VOL 0102906 m³ (m³)
- Bottom Row:**
 - Screen 14: N° 123 (N°)
 - Screen 15: E 1 0046092 MWh (E1)
 - Screen 16: E 3 0039350 MWh (E3)



DDD = 310/610

https://guides.kamstrup.com/userguides/gb_mc403.htm



MULTICAL® 403

